

Kata Palm Resort & Spa

Expanding a new Superior Building – 90 guest rooms + Facilities

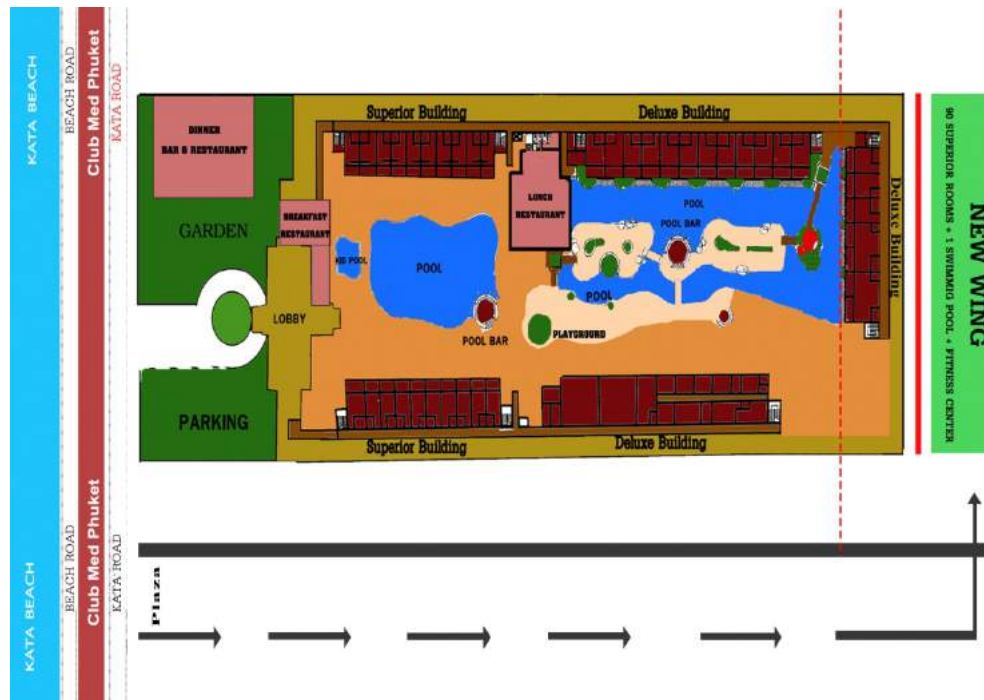

Date: 24 January 2018

Dear Valued Partner

First of all, I would like to express my sincerely thanks for your always kind patronage and support us.

We are thrilled to announce a new Superior Building project located behind of Deluxe Building, the project completion is expected in 18 months, starts from 01 May 2018 – 31 October 2019.

Construction Schedule: Duration 01 May 2018 – 31 October 2019

- New guest wing:
 - a) 90 Superior guest rooms
 - b) 1 Swimming Pool on rooftop
 - c) 1 Fitness Center.
- The contractors are authorized to work from 09:00 hrs to 18:00 hrs.

The access to construction site, we are using a private plaza road is next to our Kata Palm Resort to the work zone which is not affect to our clients. See the above map.

We will certainly do our best to keep the construction disturbance to the very minimum, but would like to apologize in advance for any inconvenience this might cause during your clients stay with us. Please be informed that utmost efforts will be made to limit the amount of noise or disruption during the construction and that our highest priority will be your safety.

We thank you in advance for your patience, understanding and cooperation during these essential works.

If you have any questions or any comment about the scheme, please feel free to contact us at anytime.

Yours sincerely,
Sumonrat Na Takuathung
Group GM Sales and Marketing
Kata Palm + Rawai Palm + Maikhao Palm, PHUKET